

# WATERBURY ROAD

## DRAWING LIST:

INDEX: ARCHITECTURE

FAAS  
601 - 1812 4 ST SW, CALGARY, AB T2S 1W1

DP.001	CONTEXT AND BUILDING INFORMATION
DP.002	SITE SURVEY & PHOTO
DP.003	FIRE AND WASTE & RECYCLING DETAILS
DP.004	TRAFFIC CIRCULATION PLAN
DP.100	SITE PLAN
DP.201	S/PLEX FLOOR PLANS BUILDINGS#3,4,7-10
DP.202	S/PLEX FLOOR & ROOF PLANS BUILDINGS#3,4,7-10
DP.203	8/PLEX BUILDINGS#1,2,5,6 FLOOR PLANS
DP.204	8/PLEX BUILDINGS#1,2,5,6 FLOOR & ROOF PLANS
DP.401	UNIT PLANS
DP.402	UNIT PLANS
DP.601	EXT. ELEV. (S/PLEX) COLOR SCHEME 1 - BLDG 1,5,8
DP.602	EXT. ELEV. (S/PLEX) COLOR SCHEME 2 - BLDG 2,4,10
DP.603	EXT. ELEV. (S/PLEX) COLOR SCHEME 3 - BLDG 3,6,7,9
DP.604	PERSPECTIVES

## PARCEL ADDRESS:

LEGAL:  
MUNICIPAL: CHESTERMERE, AB  
COMMUNITY:  
ZONING: LOW RISE MULTI-UNIT RESIDENTIAL DISTRICT (R-4)

## SETBACKS:

NORTH: 3.0 METERS  
EAST: 6.0 METERS  
SOUTH: 6.0 METERS  
WEST: 6.0 METERS

## VEHICULAR PARKING CALCULATIONS:

	RESIDENTIAL (MINIMUM 2.0 STALLS PER UNIT)	VISITOR (MINIMUM 0.15 STALLS PER UNIT)	BARRIER- FREE STALLS	TOTAL
REQUIRED STALLS	124			124
PROVIDED	124	5	1	130

## PARCEL COVERAGE:

SITE AREA: 11,609.76 SQ.M. (124,966.42 SQ.FT.)  
TOTAL BUILDING FOOT PRINT: 3961.697 SQ.M. (42,643.35 SQ.FT.)  
PROPOSED COVERAGE: 34.12%

## AMENITY SPACE:

- BALCONY, DECK OR PATIO MUST NOT BE LOCATED IN SETBACK.
- HAS MIN. AREA OF 6.0 M.SQ. OR 10% OF SITE WHICH EVER IS GREATER

## FLOOR AREA RATIO:

MAXIMUM: N/A  
PROPOSED: 1.02

## BICYCLE PARKING:

REQUIRED: 7 STALLS  
PROVIDED: 8 STALLS

## BUILDING AREA TOTAL:

FLOOR	GROSS (SQ.M.)	SQ.FT.
MARK:	3,365	42,979
SECOND:	3,938	42,389
THIRD:	3,993	42,980
TOTAL:	11,896	128,048

## DENSITY:

MAXIMUM ALLOWED: 80.0 UNITS/ha = 94.69 UNITS  
MINIMUM ALLOWED: 35.0 UNITS/ha = 41.43 UNITS  
PROPOSED DENSITY: 53.45 UNITS/ha  
TOTAL PROPOSED UNITS: 62 UNITS

## BUILDING HEIGHT:

MAXIMUM HEIGHT: 12.0 METERS OR 3 STOREYS

## ISSUED FOR DP LITE

2024.06.19

## PARCEL ADDRESS:

LEGAL: CHESTERMERE, AB  
MUNICIPAL:

## PROJECT NUMBER:

24.23 TRU\_WR



FORMED ALLIANCE ARCHITECTURE STUDIO

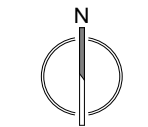

NO	DESCRIPTION	DATE
A	PRE-DP REVIEW	2024.06.12
B	DP LITE	2024.06.19

CONSTRUCTION

TENDER

BUILDING PERMIT

MUNICIPAL ADDRESS

CHESTERMERE, AB

LEGAL ADDRESS

PROJECT NUMBER

24.23 TRU\_WR

DRAWN CHECKED

VJ

DATE SCALE

2024.06.19 As indicated

DRAWING TITLE

CONTEXT AND BUILDING INFORMATION

DRAWING NUMBER

DP.001

Copyright reserved. This drawing and all copyright therein are the sole and exclusive property of the consultant. Reproduction or use of this drawing in whole or in part is prohibited and may not be used without the written consent of FAAS Architecture. Do not scale this drawing.

SITE PHASE LEGEND

PHASE#A	PHASE#1A
- MOBILIZE & SITE PREP - DEEP SERVICES AND CONNECTION TO EXISTING SERVICES - ROADWAY ASPHALT ONLY - SHALLOW SERVICES AS REQUIRED - FIRE HYDRANT & BOLLARD PROTECTION - WASTE & RECYCLING AREA - MAIL BOX - PARKING STALLS	- WALKWAYS, LANDSCAPE & SITE DEVELOPMENT - DRIVEWAY
PHASE#1	PHASE#2A
- BUILDING #1 CONSTRUCTION - DRIVEWAY	- WALKWAYS, LANDSCAPE & SITE DEVELOPMENT - DRIVEWAY
PHASE#2	PHASE#3A
- BUILDING #2 CONSTRUCTION - DRIVEWAY	- WALKWAYS, LANDSCAPE & SITE DEVELOPMENT - DRIVEWAY
PHASE#3	PHASE#4A
- BUILDING #3 CONSTRUCTION - DRIVEWAY	- WALKWAYS, LANDSCAPE & SITE DEVELOPMENT - DRIVEWAY
PHASE#4	PHASE#5A
- BUILDING #4 CONSTRUCTION - DRIVEWAY	- WALKWAYS, LANDSCAPE & SITE DEVELOPMENT - DRIVEWAY
PHASE#5	PHASE#6A
- BUILDING #5 CONSTRUCTION - DRIVEWAY	- WALKWAYS, LANDSCAPE & SITE DEVELOPMENT - DRIVEWAY
PHASE#6	PHASE#7A
- BUILDING #6 CONSTRUCTION - DRIVEWAY	- WALKWAYS, LANDSCAPE & SITE DEVELOPMENT - DRIVEWAY
PHASE#7	PHASE#8A
- BUILDING #7 CONSTRUCTION - DRIVEWAY	- WALKWAYS, LANDSCAPE & SITE DEVELOPMENT - DRIVEWAY
PHASE#8	PHASE#9A
- BUILDING #8 CONSTRUCTION - DRIVEWAY	- WALKWAYS, LANDSCAPE & SITE DEVELOPMENT - DRIVEWAY
PHASE#9	PHASE#10A
- BUILDING #9 CONSTRUCTION - DRIVEWAY	- WALKWAYS, LANDSCAPE & SITE DEVELOPMENT - DRIVEWAY
PHASE#10	
- BUILDING #10 CONSTRUCTION - DRIVEWAY	
GENERAL NOTES: - FINAL LIFT OF ASPHALT TO BE LAID WITH FINAL PHASE INCLUDING ALL SURFACE PAINTING, MARKERS & SYMBOLS. - EACH BUILDING PHASE AND ALL SURROUNDING LANDSCAPING TO BE PHASED INDIVIDUALLY AND IN A RANDOM ORDER, INDEPENDENT OF EACH OTHER. - PHASES NOT COMPLETED IN SEQUENTIAL ORDER.	

BUILDING AREA STATISTICS			BUILDING AREA STATISTICS		
LEVEL	AREA	AREA (SQ.FT.)	LEVEL	AREA	AREA (SQ.FT.)
5-PLEX			8-PLEX		
BLDG #3			BLDG #1		
T/O MAIN FLOOR	322 m <sup>2</sup>	3462 ft <sup>2</sup>	T/O MAIN FLOOR	509 m <sup>2</sup>	5476 ft <sup>2</sup>
T/O LEVEL 2	318 m <sup>2</sup>	3420 ft <sup>2</sup>	T/O LEVEL 2	508 m <sup>2</sup>	5468 ft <sup>2</sup>
T/O LEVEL 3	323 m <sup>2</sup>	3479 ft <sup>2</sup>	T/O LEVEL 3	514 m <sup>2</sup>	5527 ft <sup>2</sup>
	963 m <sup>2</sup>	10361 ft <sup>2</sup>		1530 m <sup>2</sup>	16471 ft <sup>2</sup>

BLDG #4			BLDG #2		
T/O MAIN FLOOR	322 m <sup>2</sup>	3462 ft <sup>2</sup>	T/O MAIN FLOOR	509 m <sup>2</sup>	5476 ft <sup>2</sup>
T/O LEVEL 2	318 m <sup>2</sup>	3420 ft <sup>2</sup>	T/O LEVEL 2	508 m <sup>2</sup>	5468 ft <sup>2</sup>
T/O LEVEL 3	323 m <sup>2</sup>	3479 ft <sup>2</sup>	T/O LEVEL 3	514 m <sup>2</sup>	5527 ft <sup>2</sup>
	963 m <sup>2</sup>	10361 ft <sup>2</sup>		1530 m <sup>2</sup>	16471 ft <sup>2</sup>

BLDG #7			BLDG #5		
T/O MAIN FLOOR	322 m <sup>2</sup>	3462 ft <sup>2</sup>	T/O MAIN FLOOR	509 m <sup>2</sup>	5476 ft <sup>2</sup>
T/O LEVEL 2	318 m <sup>2</sup>	3420 ft <sup>2</sup>	T/O LEVEL 2	508 m <sup>2</sup>	5468 ft <sup>2</sup>
T/O LEVEL 3	323 m <sup>2</sup>	3479 ft <sup>2</sup>	T/O LEVEL 3	514 m <sup>2</sup>	5527 ft <sup>2</sup>
	963 m <sup>2</sup>	10361 ft <sup>2</sup>		1530 m <sup>2</sup>	16471 ft <sup>2</sup>

BLDG #8			BLDG #6		
T/O MAIN FLOOR	322 m <sup>2</sup>	3462 ft <sup>2</sup>	T/O MAIN FLOOR	509 m <sup>2</sup>	5476 ft <sup>2</sup>
T/O LEVEL 2	318 m <sup>2</sup>	3420 ft <sup>2</sup>	T/O LEVEL 2	508 m <sup>2</sup>	5468 ft <sup>2</sup>
T/O LEVEL 3	323 m <sup>2</sup>	3479 ft <sup>2</sup>	T/O LEVEL 3	514 m <sup>2</sup>	5527 ft <sup>2</sup>
	963 m <sup>2</sup>	10361 ft <sup>2</sup>		1530 m <sup>2</sup>	16471 ft <sup>2</sup>

BLDG #9			TOTAL G.F.A.:		
T/O MAIN FLOOR	322 m <sup>2</sup>	3462 ft <sup>2</sup>	30	11896 m <sup>2</sup>	128048 ft <sup>2</sup>
T/O LEVEL 2	318 m <sup>2</sup>	3420 ft <sup>2</sup>			
T/O LEVEL 3	323 m <sup>2</sup>	3479 ft <sup>2</sup>			
	963 m <sup>2</sup>	10361 ft <sup>2</sup>			

BLDG #10		
T/O MAIN FLOOR	322 m <sup>2</sup>	3462 ft <sup>2</sup>
T/O LEVEL 2	318 m <sup>2</sup>	3420 ft <sup>2</sup>
T/O LEVEL 3	323 m <sup>2</sup>	3479 ft <sup>2</sup>
	963 m <sup>2</sup>	10361 ft <sup>2</sup>

BUILDING IDENTIFICATION LEGEND

- COLOR SCHEME 1
- COLOR SCHEME 2
- COLOR SCHEME 3

EXISTING POND

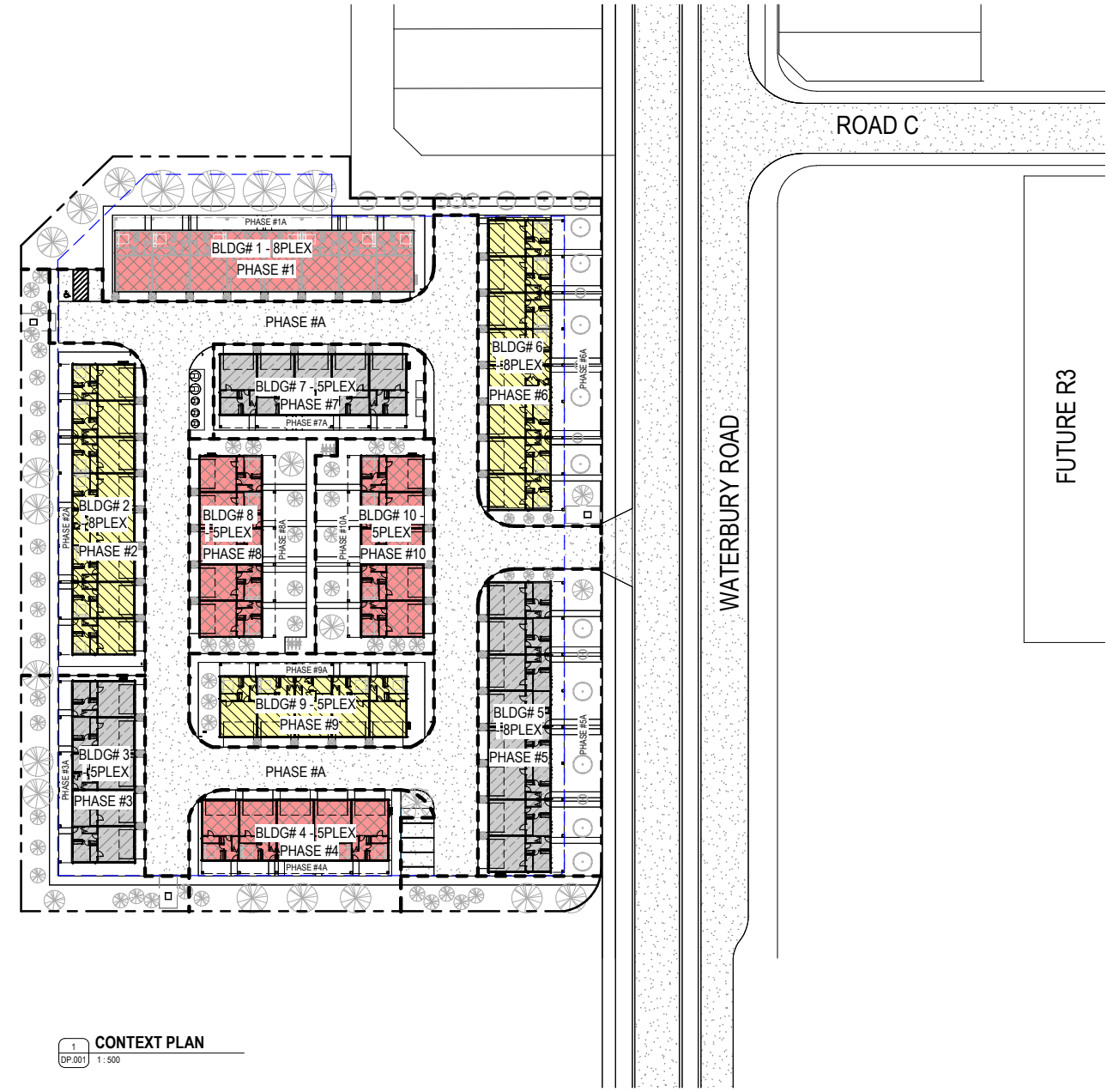

1 CONTEXT PLAN  
DP.001 1:500

FILE PATH: Area\8 Doc\1A\24.06.19 TRU\_WR\24.23 TRU\_WR SET\ME\TC\_0827.rvt  
PLOT DATE: 2024/06/19 09:03 AM

FOR REFERENCE ONLY - NOT FOR CONSTRUCTION

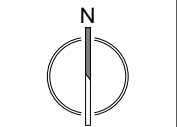

RELEASES		
NO	DESCRIPTION	DATE
A	PRE-DP REVIEW	2024.06.12
B	DP LITE	2024.06.19

CONSTRUCTION

TENDER

BUILDING PERMIT

MUNICIPAL ADDRESS

CHESTERMERE, AB

LEGAL ADDRESS

PROJECT NUMBER

24.23 TRU\_WR

DRAWN

CHECKED

VJ

DATE

SCALE

2024.06.19

1:700

DRAWING TITLE

**SITE SURVEY & PHOTO**

DRAWING NUMBER

**DP.002**

Copyright reserved. This drawing and all copyright therein are the sole and exclusive property of the consultant. Reproduction or use of this drawing in whole or in part is prohibited and may not be used without the written consent of FAAS Architecture. Do not scale this drawing.

A - NE CORNER SITE PHOTO

B - SE CORNER SITE PHOTO

C - SW CORNER SITE PHOTO

D - NW CORNER SITE PHOTO

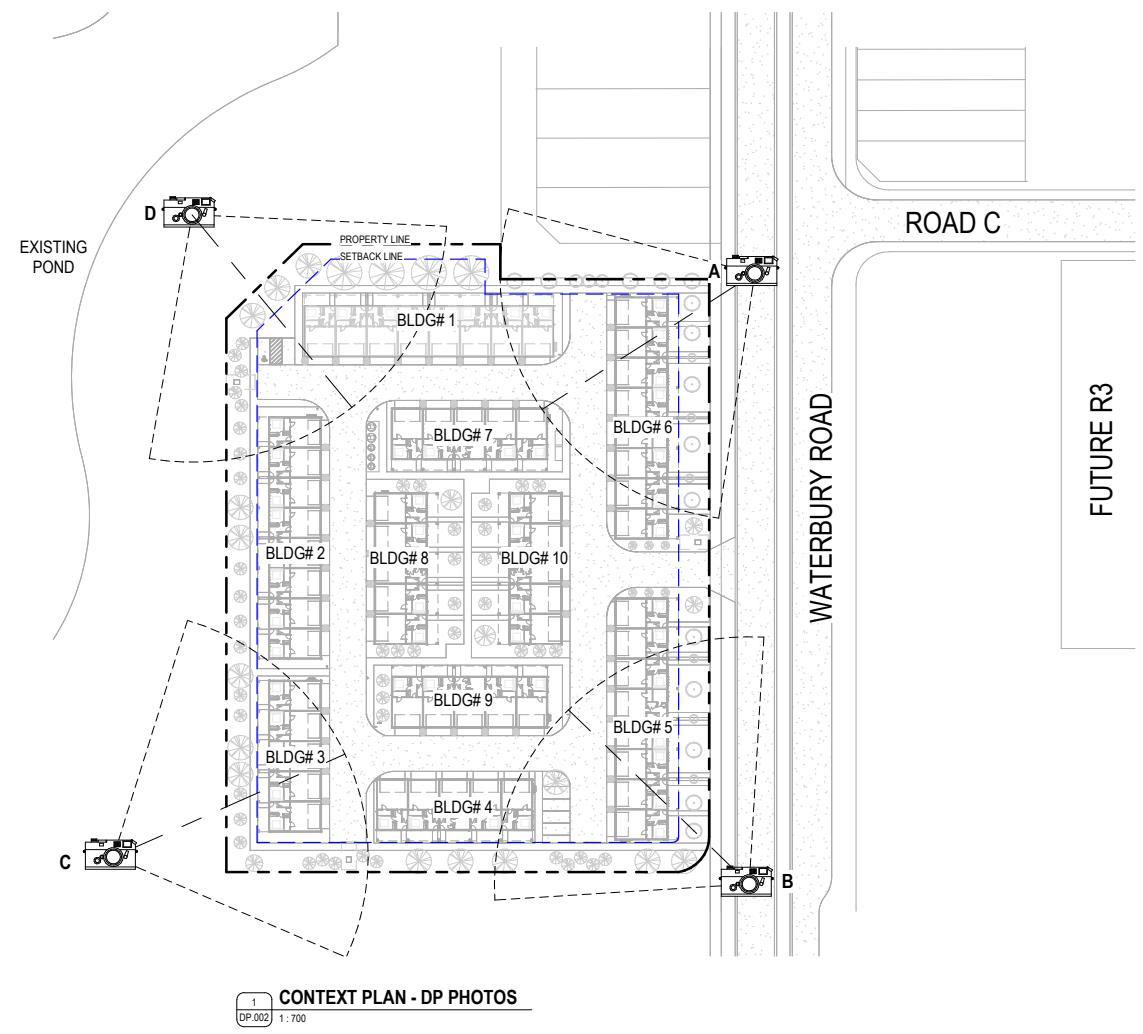

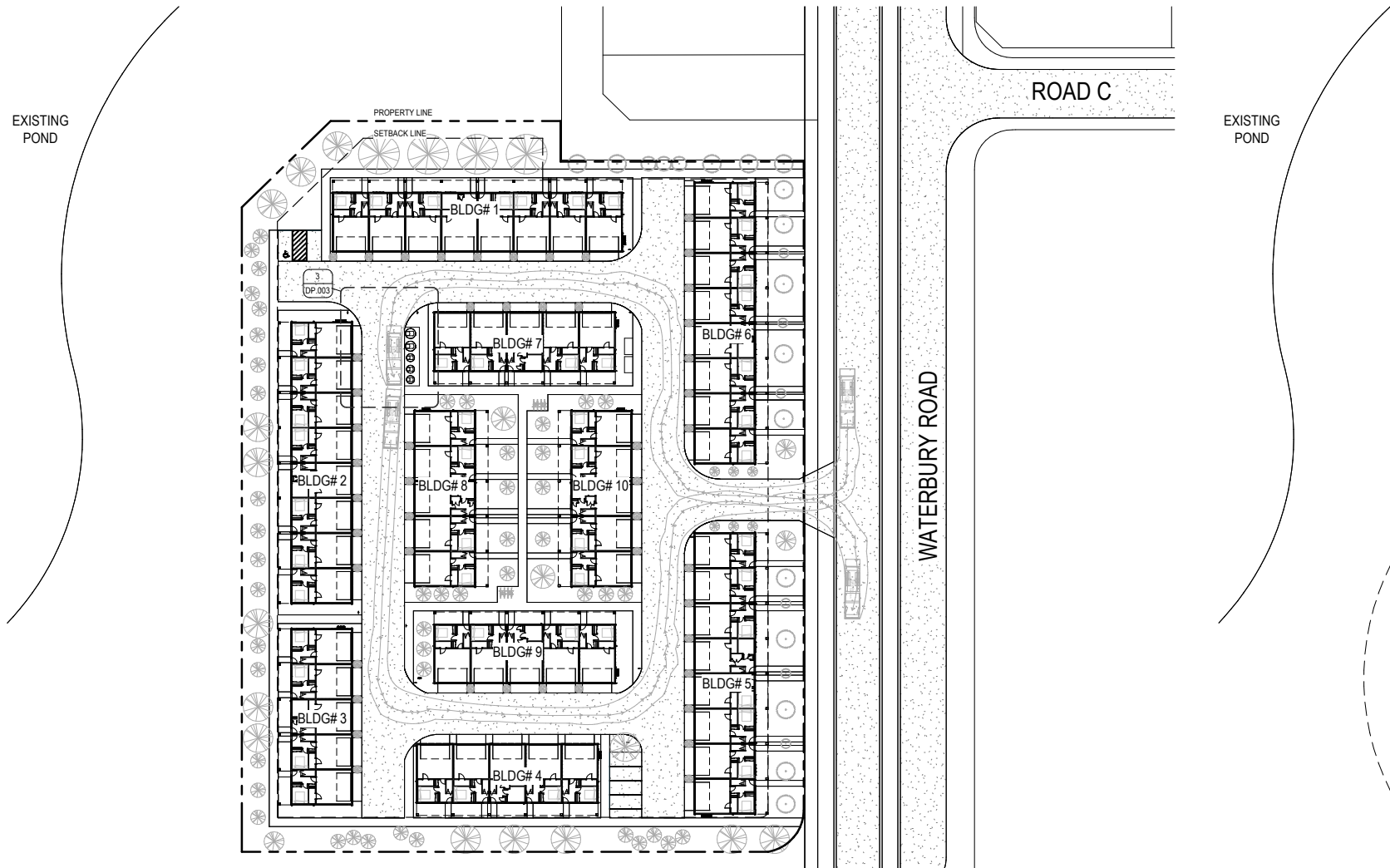

1 SITE PLAN - WASTE COLLECTION ACCESS  
DP.003 1:500



2 SITE PLAN - FIRE FIGHTING ACCESS  
DP.003 1:500

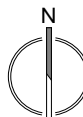

NO	DESCRIPTION	DATE
A	PRE-DP REVIEW	2024.06.12
B	DP LITE	2024.06.19

CONSTRUCTION  
 TENDER  
 BUILDING PERMIT

MUNICIPAL ADDRESS:  
**CHESTERMERE, AB**

LEGAL ADDRESS:

PROJECT NUMBER:  
**24.23 TRU\_WR**

DRAWN:  CHECKED:

DATE: 2024.06.19 SCALE: As indicated

DRAWING TITLE:  
**FIRE AND WASTE & RECYCLING DETAILS**

DRAWING NUMBER:

**DP.003**

Copyright reserved. This drawing and all copyright therein are the sole and exclusive property of the consultant. Reproduction or use of this drawing in whole or in part is prohibited and may not be used without the written consent of FAAS Architecture. Do not scale this drawing.

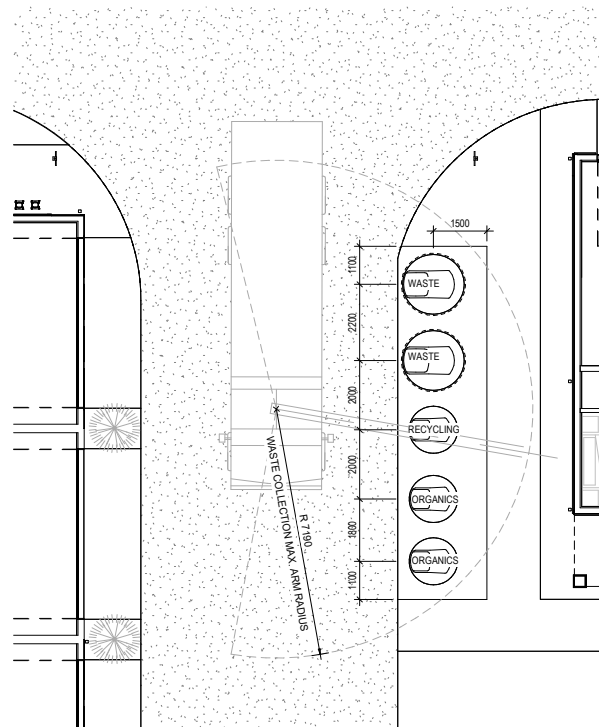

3 SITE PLAN - DETAIL (WASTE)  
DP.003 1:100

### WASTE / RECYCLING / ORGANICS STATISTIC & CALCULATIONS

WASTE / RECYCLING / ORGANICS STATISTIC & CALCULATIONS					
	WASTE DIVERSION PERCENTAGE (%)	REQUIRED WASTE VOLUME (m³)	PROVIDED WASTE VOLUME (m³)	PROPOSED BINS	PICK UP FREQUENCY PER WEEK
RECYCLING	12%	2.0 m³	3.0 m³	1 x 3.0 m³	1
GARBAGE / WASTE	57%	7.9 m³	10.0 m³	2 x 5.0 m³	1
ORGANICS	31%	5.0 m³	6.0 m³	2 x 3.0 m³	1
TOTAL	100%	14.9 m³	19.0 m³	5 TOTAL	1

62 UNITS x 24 m³ / WEEK

### MOLOK WASTE BIN ENCLOSURE DETAIL

NOT TO SCALE

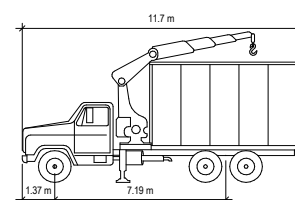

MOLOK WASTE COLLECTION TRUCK

WIDTH: 2.47 m  
TRACK: 2.47 m  
LOCK TO LOCK TIME: 6.0 s  
STEERING ANGLE: 53.0 deg

MOLOK TRUCK PROFILE

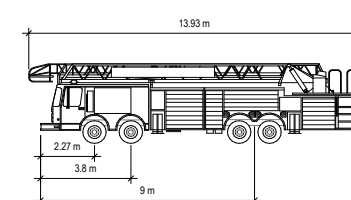

CFD BRONTO SKYLIFT

WIDTH: 2.57 m  
TRACK: 2.57 m  
LOCK TO LOCK TIME: 6.0 s  
STEERING ANGLE: 47.5 deg  
TURNING RADIUS: 10.18 M

COC FIRE TRUCK PROFILE

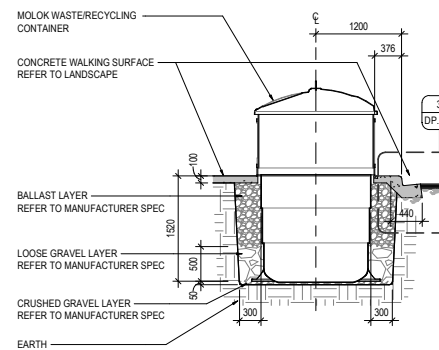

4 MOLOK SECTION  
DP.003 1:50



STOP SIGN  
TYPE 'A'



PEDESTRIAN  
CROSSING  
TYPE 'B'



BARRIER-FREE PARKING ONLY  
(ON KNOCK-DOWN POST)  
TYPE 'C'



NO PARKING  
TYPE 'D'



SPEED LIMIT  
TYPE 'E'

### SITE SIGNAGE TYPE

NOTE: ALL SIGNS TO CITY OF CALGARY STANDARDS AND MOUNT TO STANDARD POSTS UNLESS NOTED OTHERWISE. REFER TO SITE PLAN FOR LOCATIONS.

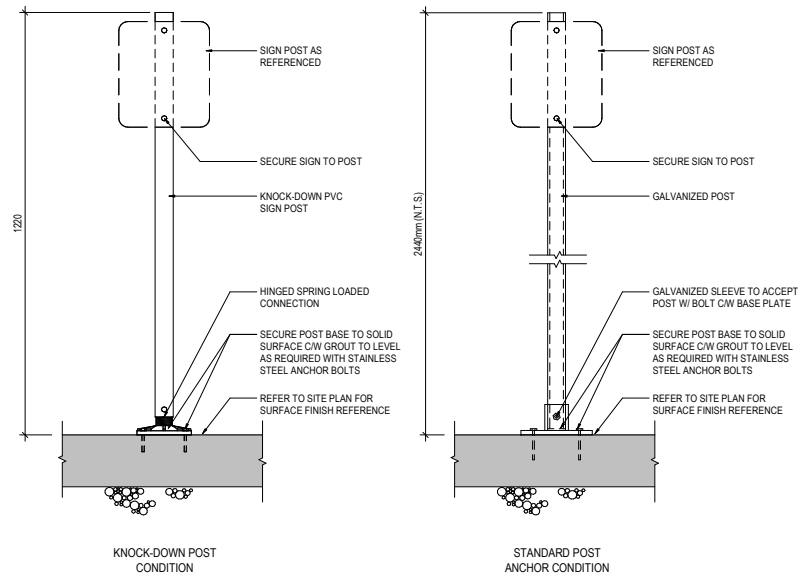

### SITE SIGNAGE MOUNTING REFERENCE

NOTE: REFER TO SIGNAGE TYPE DETAIL AND SITE PLAN

### 2 SIGNAGE TYPE & DETAIL DP.004 1:10

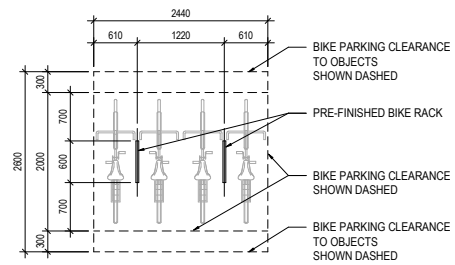

### 3 BIKE RACK DP.004 1:50

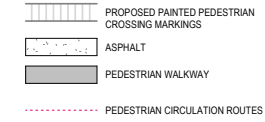

### SHEET NOTES

N.	DESCRIPTION
N.01	VISITOR PARKING STALLS
N.02	BARRIER-FREE PARKING STALLS
N.03	RESIDENT PARKING - 2 STALLS (IN GARAGE)
N.04	BIKE PARKING

SGN.	PROPOSED SITE SIGN
SGN.A	TYPE A - STOP SIGN
SGN.B	TYPE B - PEDESTRIAN CROSSING
SGN.C	TYPE C - BARRIER FREE PARKING ONLY
SGN.D	TYPE D - NO PARKING
SGN.E	TYPE E - SPEED LIMIT
SGN.F	TYPE F - SHARE THE ROAD

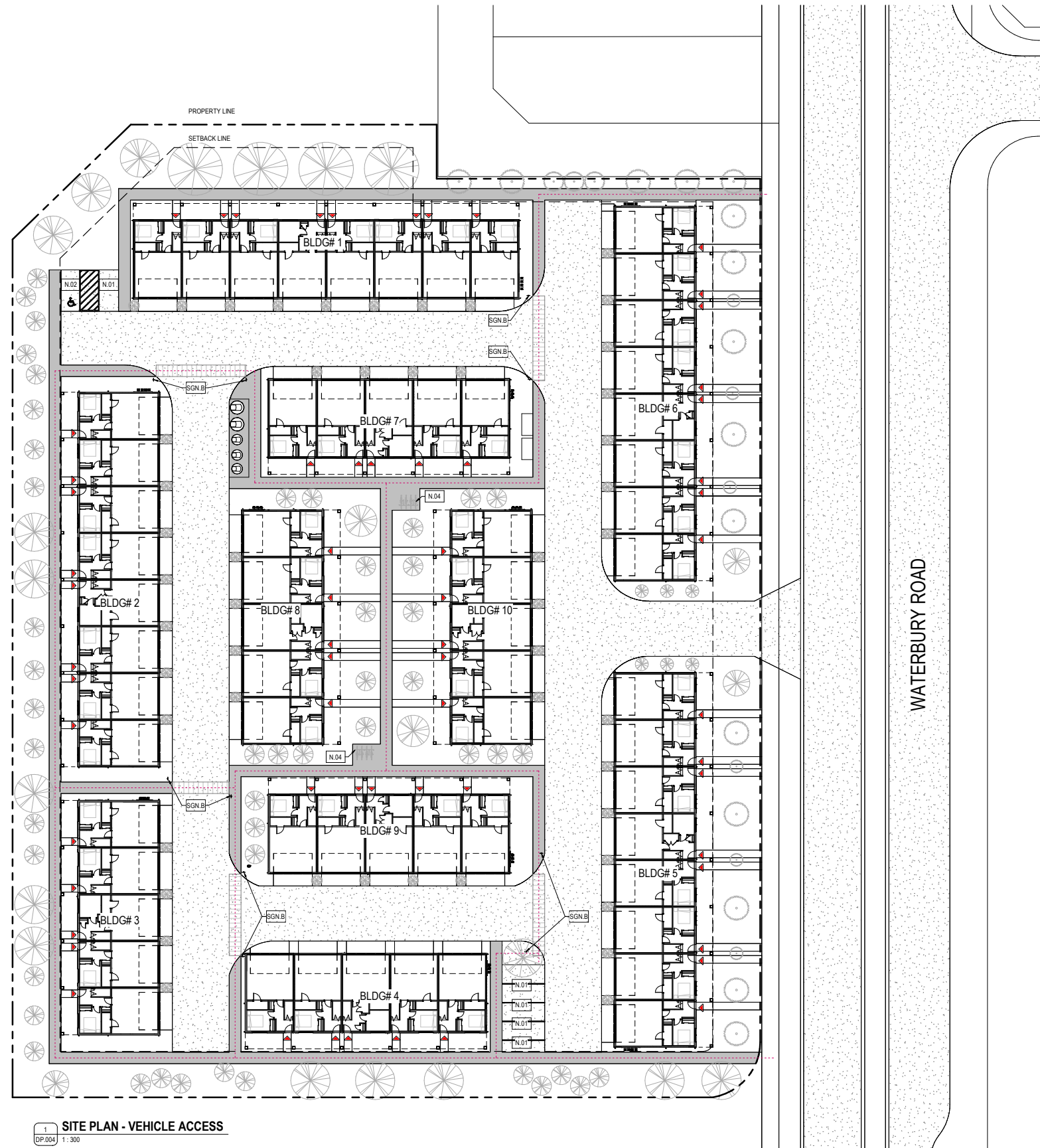

### 1 SITE PLAN - VEHICLE ACCESS DP.004 1:300

FOR REFERENCE ONLY - NOT FOR CONSTRUCTION

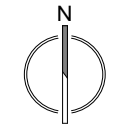

### RELEASES

NO	DESCRIPTION	DATE
A	PRE-DP REVIEW	2024.06.12
B	DP LITE	2024.06.19

<input type="checkbox"/>	CONSTRUCTION
<input type="checkbox"/>	TENDER
<input type="checkbox"/>	BUILDING PERMIT
MUNICIPAL ADDRESS	
CHESTERMERE, AB	
LEGAL ADDRESS	

PROJECT NUMBER  
24.23 TRU\_WR

DRAWN CHECKED  
VJ

DATE SCALE  
2024.06.19 As indicated

DRAWING TITLE  
TRAFFIC CIRCULATION PLAN  
DRAWING NUMBER

# DP.004

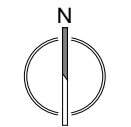

RELEASES

NO	DESCRIPTION	DATE
A	PRE-DP REVIEW	2024.06.12
B	DP LITE	2024.06.19

CONSTRUCTION  
 TENDER  
 BUILDING PERMIT  
 MUNICIPAL ADDRESS  
 CHESTERMERE, AB  
 LEGAL ADDRESS

PROJECT NUMBER  
 24.23 TRU\_WR  
 DRAWN CHECKED  
 VJ  
 DATE SCALE  
 2024.06.19 As indicated

DRAWING TITLE  
**SITE PLAN**  
 DRAWING NUMBER

**DP.100**

Copyright reserved. This drawing and all copyright therein are the sole and exclusive property of the consultant. Reproduction or use of this drawing in whole or in part is prohibited and may not be used without the written consent of FAAS Architecture. Do not scale this drawing.

- SHEET NOTES**
- N.01 WASTE & RECYCLING AREA (REFER TO ENLARGED DETAIL 3 / DP.003)
  - N.02 TRANSFORMER LOCATION
  - N.03 EXISTING ELECTRICAL PULLBOX / SWITCH / TRANSFORMER
  - N.04 UTILITY RIGHT OF WAY
  - N.05 FIRE HYDRANT
  - N.06 MANHOLE / CATCH BASIN
  - N.07 VISITOR PARKING STALLS
  - N.08 BARRIER-FREE PARKING STALLS
  - N.09 MAIL BOX
  - N.10 ASPHALT SURFACE
  - N.11 HEAVY DUTY ASPHALT SURFACE DESIGNED TO SUPPORT 38,556KG / 85,000LBS AND DESIGNED TO SUPPORT THE NFPA 1901 POINT LOAD OF 517KPA (79PSI) OVER A 24"x24" AREA WHICH CORRESPONDS TO THE OUTRIGGER PAD SIZE
  - N.12 CONCRETE WALKWAY
  - N.13 CONCRETE DRIVEWAY PAD
  - N.14 SITE SIGN - REFER TO SHEET
  - N.15 CONCRETE CURB CUT
  - N.16 BALCONY COLUMN
  - N.17 CONCRETE ROLLED CURB (REFER TO DETAIL 5 / DP.100)
  - N.18 LANDSCAPE AREA (REFER TO LANDSCAPE DRAWINGS)
  - N.19 BIKE STALLS

- PROPOSED UTILITY RIGHT OF WAY
- ASPHALT
- HEAVY DUTY ASPHALT
- PRINCIPAL ENTRANCE
- WATER METER LOCATION
- GAS METER LOCATION
- ELECTRICAL METER LOCATION
- PROPERTY LINE
- SITE SETBACK
- UTILITY RIGHT OF WAY
- WATER SERVICE - REFER TO CIVIL
- STORM SERVICE - REFER TO CIVIL
- SANITARY SERVICE - REFER TO CIVIL
- PEDESTRIAN CIRCULATION ROUTES

- GENERAL NOTES:**
- REFER TO SURVEY & CIVIL DRAWINGS FOR SITE SERVICES, UTILITY RIGHT OF WAYS, GRADING & GEODETIC ELEVATIONS.
  - REFER TO LANDSCAPE DRAWINGS FOR ALL PLANTING AND GROUND COVER / FEATURE INFORMATION & DETAILS.
  - REFER TO ELECTRICAL DRAWINGS FOR LIGHTING LAYOUT AND DETAILS.

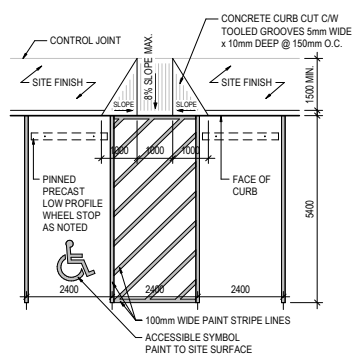
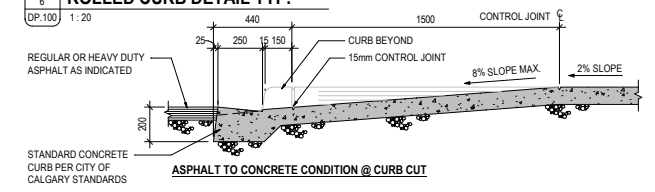
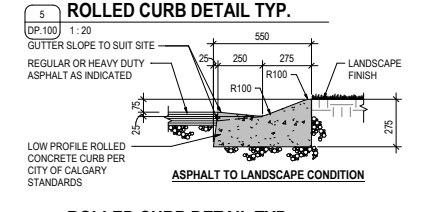
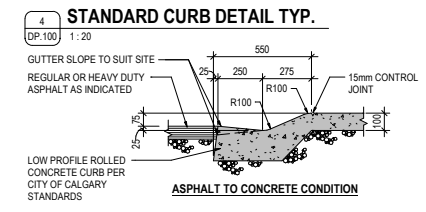
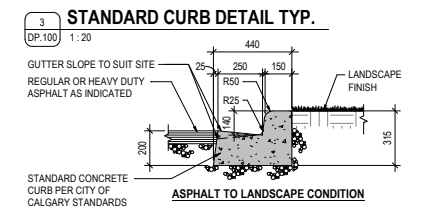
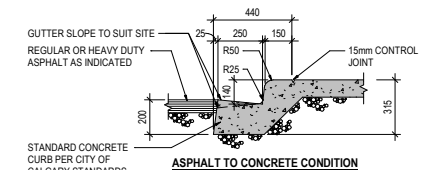
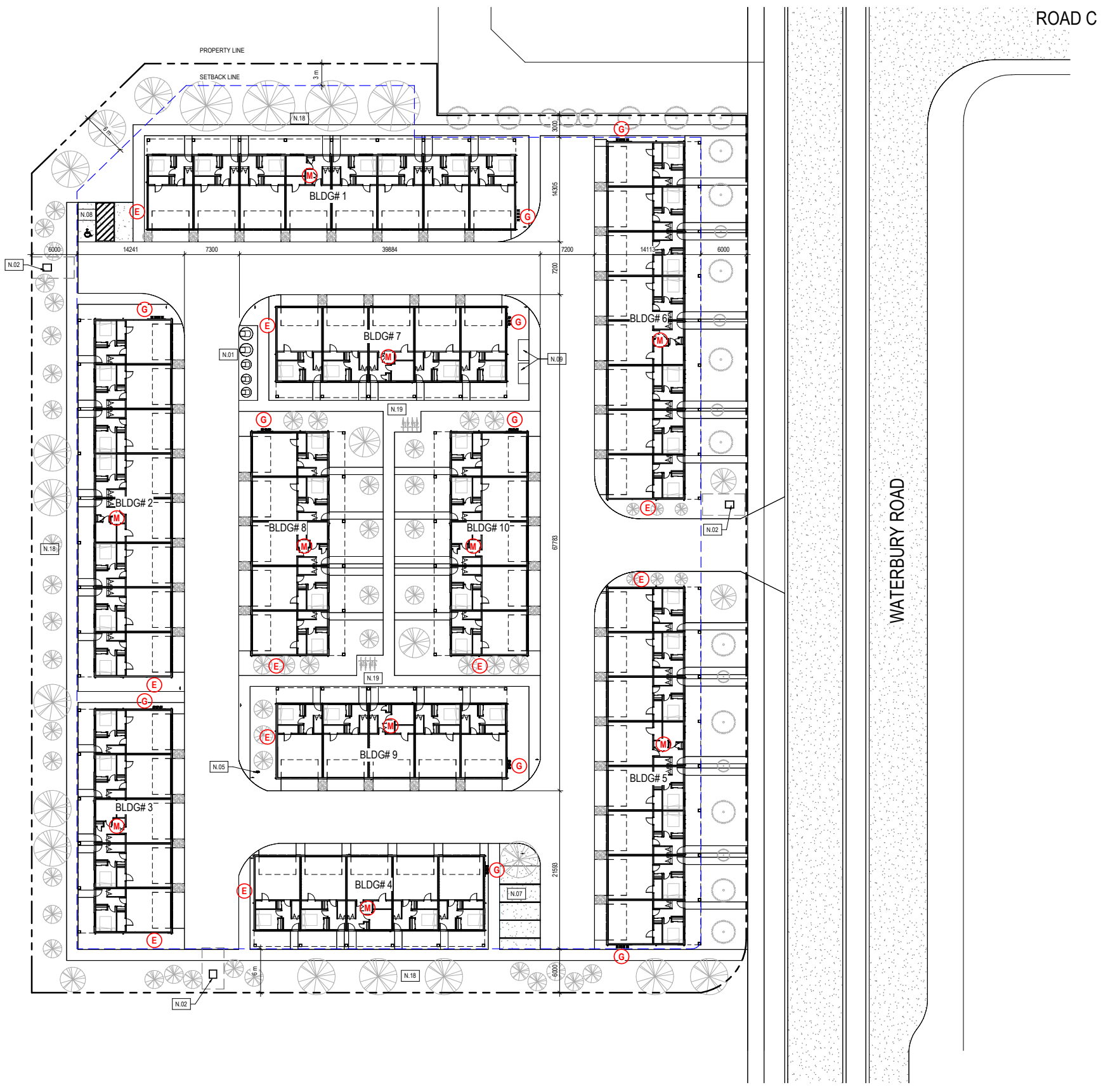

**1 SITE PLAN - DP**  
 DP.100 1:300

**8 STANDARD CURVED DETAIL TYP.**  
 DP.100 1:20

**7 STANDARD CURVED DETAIL TYP.**  
 DP.100 1:20

FOR REFERENCE ONLY - NOT FOR CONSTRUCTION



**1 FRONT ELEVATION (S)**  
DP.601 1/8" = 1'-0"



**2 REAR ELEVATION (N)**  
DP.601 1/8" = 1'-0"

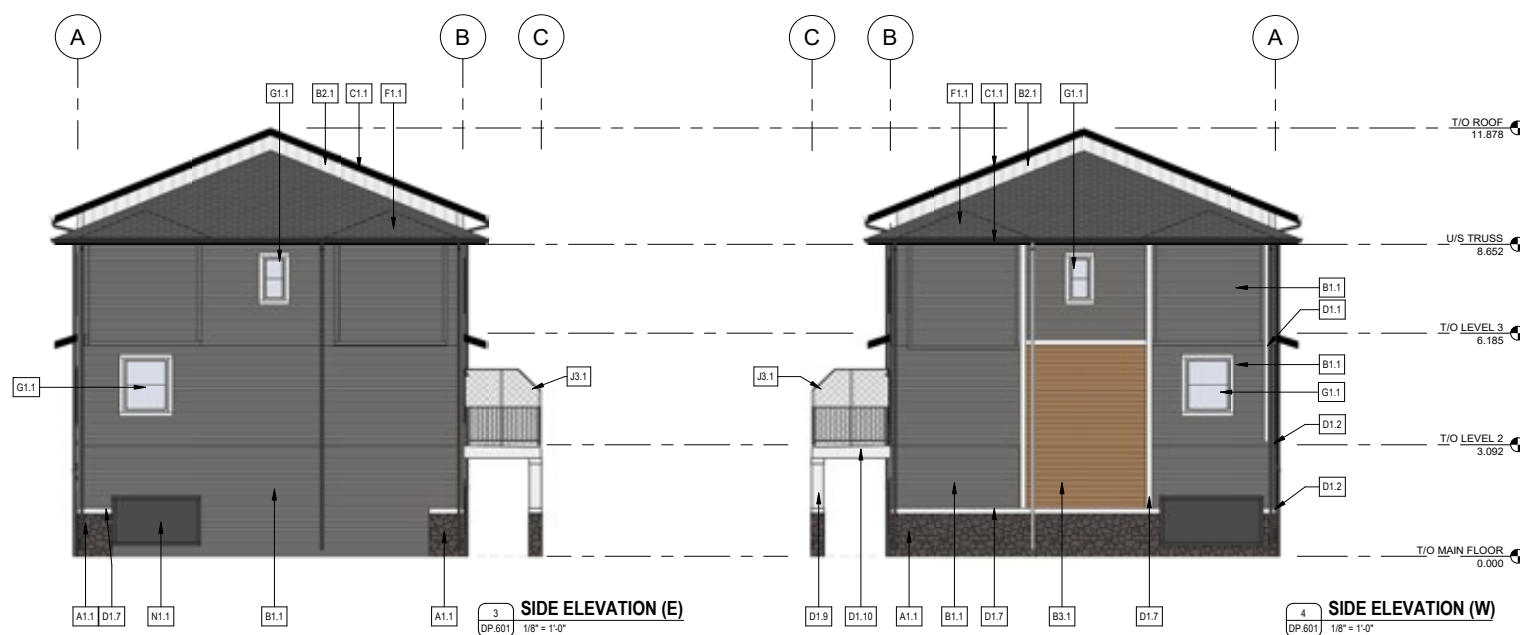

**3 SIDE ELEVATION (E)**  
DP.601 1/8" = 1'-0"

**4 SIDE ELEVATION (W)**  
DP.601 1/8" = 1'-0"

**EXTERIOR FINISH LEGEND**

- A - STONE CLADDING**
  - A1.1 MANUFACTURED STONE VENEER  
COLOUR = FELDSTONE - DARK BASALT
  - A1.2 MANUFACTURED STONE VENEER  
COLOUR = MOOD BRICK - LOFT BLACK
  - A1.3 MANUFACTURED STONE VENEER  
COLOUR = STACKED STONE - RUNDLE
- B - SIDING**
  - B1.1 VINYL SIDING  
COLOUR = HARVARD SLATE - DOUBLE 4"
  - B1.2 VINYL SIDING  
COLOUR = HEATHER - DOUBLE 4"
  - B1.3 VINYL SIDING  
COLOUR = WEATHERED GREY - DOUBLE 4"
  - B1.4 VINYL SIDING  
COLOUR = SILVER MIST - 4"
  - B1.5 VINYL SIDING  
COLOUR = WHITE - 8"
  - B2.1 VERTICAL SIDING  
COLOUR = WHITE
  - B3.1 WOOD SIMULATED SIDING  
COLOUR = WOOD
- C - METAL CLADDING**
  - C1.1 PRE-FINISHED METAL FASCIA & SOFFIT  
COLOUR = BLACK
  - C1.2 PRE-FINISHED METAL FASCIA & SOFFIT  
COLOUR = WHITE
- D - TRIM / PANEL**
  - D1.1 TRIM / PANEL  
COLOUR = TO MATCH HARVARD SLATE
  - D1.2 TRIM / PANEL  
COLOUR = TO MATCH HEATHER
  - D1.3 TRIM / PANEL  
COLOUR = TO MATCH WEATHERED GREY
  - D1.4 TRIM / PANEL  
COLOUR = TO MATCH MARINE BLUE
  - D1.5 TRIM / PANEL  
COLOUR = TO MATCH WHITE
  - D1.6 TRIM / PANEL  
COLOUR = TO MATCH WOOD FINISH
  - D1.7 SMARTBOARD TRIM  
COLOUR = WHITE
  - D1.8 SMARTBOARD TRIM  
COLOUR = BLACK
  - D1.9 SMARTBOARD TRIM WITH STONE BASE - COLUMNS  
COLOUR = WHITE
  - D1.10 SMOOTH PANEL  
COLOUR = WHITE
  - D1.11 SMOOTH PANEL  
COLOUR = BLACK
- E - PAVING**
  - E1.1 PAVING  
COLOUR = NATURAL
- F - ROOFING**
  - F1.1 ASPHALT ROOF SHINGLES  
COLOUR = DUAL BLACK
- G - WINDOWS**
  - G1.1 PVC WINDOWS  
COLOUR = WHITE
- H - DOORS**
  - H1.1 GARAGE DOOR  
COLOUR = WHITE
  - H1.2 GARAGE DOOR  
COLOUR = BLACK
  - H1.3 GARAGE DOOR  
COLOUR = GREY
  - H1.4 GARAGE DOOR  
COLOUR = WOOD
  - H2.1 SWING DOOR W/ GLASS LITE  
COLOUR = WHITE
  - H2.2 SWING DOOR W/ GLASS LITE  
COLOUR = BLACK
  - H2.3 SWING DOOR W/ GLASS LITE  
COLOUR = GREY
- J - GUARDS / RAILINGS**
  - J1.1 PRE-FINISHED ALUMINUM GUARDRAIL W/ PICKETS  
COLOUR = WHITE
  - J1.2 PRE-FINISHED ALUMINUM GUARDRAIL W/ PICKETS  
COLOUR = BLACK
  - J2.1 PRE-FINISHED ALUMINUM GUARDRAIL W/ GLASS PANEL  
COLOUR = WHITE
  - J2.2 PRE-FINISHED ALUMINUM GUARDRAIL W/ GLASS PANEL  
COLOUR = BLACK
  - J3.1 PRE-FINISHED METAL PRIVACY SCREEN W/ FROSTED GLASS PANEL  
COLOUR = WHITE
- K - METAL DOWNSPOUT**
  - K1.1 PRE-FINISHED METAL DOWNSPOUT  
COLOUR = WHITE
- L - LIGHTS**
  - L1.1 WALL MOUNTED  
COLOUR = BLACK
- M - SIGNAGE**
  - M1.1 METAL ADDRESS NUMBER  
COLOUR = BRUSHED NICKEL
- N - SERVICES**
  - N1.1 SERVICES PANEL SURROUND TRIM / PANEL  
COLOUR = TO MATCH ADJACENT FINISH

**RELEASES**

NO	DESCRIPTION	DATE
B	DP LITE	2024.06.19

CONSTRUCTION  
 TENDER  
 BUILDING PERMIT

MUNICIPAL ADDRESS  
**CHESTERMERE, AB**

LEGAL ADDRESS

PROJECT NUMBER  
**24.23 TRU\_WR**

DRAWN  
AMH

CHECKED  
AMH

DATE  
2024.06.19

SCALE  
As indicated

DRAWING TITLE  
**EXT. ELEV. (8PLEX) COLOR SCHEME 1 - BLDG 1,5,8**

DRAWING NUMBER  
**DP.601**

FILE PATH: \\saw\shared\170 WATERBURY\170 - 832748217 TRU WR (8PLEX) BLDG 1,5,8 MP - 8214X  
PLOT DATE: 2024/06/19 15:54:48

Copyright reserved. This drawing and all copyright therein are the sole and exclusive property of the consultant. Reproduction or use of this drawing in whole or in part is prohibited and may not be used without the written consent of FAAS Architecture. Do not scale this drawing.

EXTERIOR FINISH LEGEND

- A - STONE CLADDING
  - A1.1 MANUFACTURED STONE VENEER  
COLOUR = FIELDSTONE - DARK BASALT
  - A1.2 MANUFACTURED STONE VENEER  
COLOUR = MODRO BRICK - LOFT BLACK
  - A1.3 MANUFACTURED STONE VENEER  
COLOUR = STACKED STONE - RUNDLE
- B - SIDING
  - B1.1 VINYL SIDING  
COLOUR = HARVARD SLATE - DOUBLE 4"
  - B1.2 VINYL SIDING  
COLOUR = HEATHER - DOUBLE 4"
  - B1.3 VINYL SIDING  
COLOUR = WEATHERED GREY - DOUBLE 4"
  - B1.4 VINYL SIDING  
COLOUR = SILVER MIST - 4"
  - B1.5 VINYL SIDING  
COLOUR = WHITE - 8"
  - B2.1 VERTICAL SIDING  
COLOUR = WHITE
  - B3.1 WOOD SIMULATED SIDING  
COLOUR = WOOD
- C - METAL CLADDING
  - C1.1 PRE-FINISHED METAL FASCIA & SOFFIT  
COLOUR = BLACK
  - C1.2 PRE-FINISHED METAL FASCIA & SOFFIT  
COLOUR = WHITE
- D - TRIM / PANEL
  - D1.1 TRIM / PANEL  
COLOUR = TO MATCH HARVARD SLATE
  - D1.2 TRIM / PANEL  
COLOUR = TO MATCH HEATHER
  - D1.3 TRIM / PANEL  
COLOUR = TO MATCH WEATHERED GREY
  - D1.4 TRIM / PANEL  
COLOUR = TO MATCH MARINE BLUE
  - D1.5 TRIM / PANEL  
COLOUR = TO MATCH WHITE
  - D1.6 TRIM / PANEL  
COLOUR = TO MATCH WOOD FINISH
  - D1.7 SMARTBOARD TRIM  
COLOUR = WHITE
  - D1.8 SMARTBOARD TRIM  
COLOUR = BLACK
  - D1.9 SMARTBOARD TRIM WITH STONE BASE - COLUMNS  
COLOUR = WHITE
  - D1.10 SMOOTH PANEL  
COLOUR = WHITE
  - D1.11 SMOOTH PANEL  
COLOUR = BLACK
- E - PAVING
  - E1.1 PAVING  
COLOUR = NATURAL
- F - ROOFING
  - F1.1 ASPHALT ROOF SHINGLES  
COLOUR = DUAL BLACK
- G - WINDOWS
  - G1.1 PVC WINDOWS  
COLOUR = WHITE
- H - DOORS
  - H1.1 GARAGE DOOR  
COLOUR = WHITE
  - H1.2 GARAGE DOOR  
COLOUR = BLACK
  - H1.3 GARAGE DOOR  
COLOUR = GREY
  - H1.4 GARAGE DOOR  
COLOUR = WOOD
  - H2.1 SWING DOOR W/ GLASS LITE  
COLOUR = WHITE
  - H2.2 SWING DOOR W/ GLASS LITE  
COLOUR = BLACK
  - H2.3 SWING DOOR W/ GLASS LITE  
COLOUR = LIGHT GREY
- J - GUARDS / RAILINGS
  - J1.1 PRE-FINISHED ALUMINUM GUARDRAIL W/ PICKETS  
COLOUR = WHITE
  - J1.2 PRE-FINISHED ALUMINUM GUARDRAIL W/ PICKETS  
COLOUR = BLACK
  - J2.1 PRE-FINISHED ALUMINUM GUARDRAIL W/ GLASS PANEL  
COLOUR = WHITE
  - J2.2 PRE-FINISHED ALUMINUM GUARDRAIL W/ GLASS PANEL  
COLOUR = BLACK
  - J3.1 PRE-FINISHED METAL PRIVACY SCREEN W/ FROSTED GLASS PANEL  
COLOUR = BLACK
- K - METAL DOWNSPOUT
  - K1.1 PRE-FINISHED METAL DOWNSPOUT  
COLOUR = WHITE
- L - LIGHTS
  - L1.1 WALL MOUNTED  
COLOUR = BLACK
- M - SIGNAGE
  - M1.1 METAL ADDRESS NUMBER  
COLOUR = BRUSHED NICKEL
- N - SERVICES
  - N1.1 SERVICES PANEL SURROUND TRIM / PANEL  
COLOUR TO MATCH ADJACENT FINISH



1 SIDE ELEVATION (SW)  
DP.602 1/8" = 1'-0"

2 FRONT ELEVATION (SE)  
DP.602 1/8" = 1'-0"



3 SIDE ELEVATION (NE)  
DP.602 1/8" = 1'-0"

4 REAR ELEVATION (NW)  
DP.602 1/8" = 1'-0"

FOR REFERENCE ONLY - NOT FOR CONSTRUCTION

RELEASES

NO	DESCRIPTION	DATE
B	DP LITE	2024.06.19

- CONSTRUCTION
- TENDER
- BUILDING PERMIT

MUNICIPAL ADDRESS

CHESTERMERE, AB

LEGAL ADDRESS

PROJECT NUMBER

24.23 TRU\_WR

DRAWN CHECKED  
KIA AMH

DATE SCALE

2024.06.19 As indicated

DRAWING TITLE

EXT. ELEV. (5PLEX) COLOR SCHEME 2 - BLDG 2,4,10

DRAWING NUMBER

DP.602



**EXTERIOR FINISH LEGEND**

- A - STONE CLADDING**
  - A1.1 MANUFACTURED STONE VENEER  
COLOUR = FIELDSTONE - DARK BASALT
  - A1.2 MANUFACTURED STONE VENEER  
COLOUR = MODERN BRICK - LOFT BLACK
  - A1.3 MANUFACTURED STONE VENEER  
COLOUR = STACKED STONE - RUNDLE
- B - SIDING**
  - B1.1 VINYL SIDING  
COLOUR = HARVARD SLATE - DOUBLE 4"
  - B1.2 VINYL SIDING  
COLOUR = HEATHER - DOUBLE 4"
  - B1.3 VINYL SIDING  
COLOUR = WEATHERED GREY - DOUBLE 4"
  - B1.4 VINYL SIDING  
COLOUR = SILVER MIST - 4"
  - B1.5 VINYL SIDING  
COLOUR = WHITE - 8"
  - B2.1 VERTICAL SIDING  
COLOUR = WHITE
  - B3.1 WOOD SIMULATED SIDING  
COLOUR = WOOD
- C - METAL CLADDING**
  - C1.1 PRE-FINISHED METAL FASCIA & SOFFIT  
COLOUR = BLACK
  - C1.2 PRE-FINISHED METAL FASCIA & SOFFIT  
COLOUR = WHITE
- D - TRIM / PANEL**
  - D1.1 TRIM / PANEL  
COLOUR = TO MATCH HARVARD SLATE
  - D1.2 TRIM / PANEL  
COLOUR = TO MATCH HEATHER
  - D1.3 TRIM / PANEL  
COLOUR = TO MATCH WEATHERED GREY
  - D1.4 TRIM / PANEL  
COLOUR = TO MATCH MARINE BLUE
  - D1.5 TRIM / PANEL  
COLOUR = TO MATCH WHITE
  - D1.6 TRIM / PANEL  
COLOUR = TO MATCH WOOD FINISH
  - D1.7 SMARTBOARD TRIM  
COLOUR = WHITE
  - D1.8 SMARTBOARD TRIM  
COLOUR = BLACK
  - D1.9 SMARTBOARD TRIM WITH STONE BASE - COLUMNS  
COLOUR = WHITE
  - D1.10 SMOOTH PANEL  
COLOUR = WHITE
  - D1.11 SMOOTH PANEL  
COLOUR = BLACK
- E - PAVING**
  - E1.1 PAVING  
COLOUR = NATURAL
- F - ROOFING**
  - F1.1 ASPHALT ROOF SHINGLES  
COLOUR = DUAL BLACK
- G - WINDOWS**
  - G1.1 PVC WINDOWS  
COLOUR = WHITE
- H - DOORS**
  - H1.1 GARAGE DOOR  
COLOUR = WHITE
  - H1.2 GARAGE DOOR  
COLOUR = BLACK
  - H1.3 GARAGE DOOR  
COLOUR = GREY
  - H1.4 GARAGE DOOR  
COLOUR = WOOD
  - H2.1 SWING DOOR W/ GLASS LITE  
COLOUR = WHITE
  - H2.2 SWING DOOR W/ GLASS LITE  
COLOUR = BLACK
  - H2.3 SWING DOOR W/ GLASS LITE  
COLOUR = LIGHT GREY
- J - GUARDS / RAILINGS**
  - J1.1 PRE-FINISHED ALUMINUM GUARDRAIL W/ PICKETS  
COLOUR = WHITE
  - J1.2 PRE-FINISHED ALUMINUM GUARDRAIL W/ PICKETS  
COLOUR = BLACK
  - J2.1 PRE-FINISHED ALUMINUM GUARDRAIL W/ GLASS PANEL  
COLOUR = WHITE
  - J2.2 PRE-FINISHED ALUMINUM GUARDRAIL W/ GLASS PANEL  
COLOUR = BLACK
  - J3.1 PRE-FINISHED METAL PRIVACY SCREEN W/ FROSTED  
GLASS PANEL  
COLOUR = BLACK
- K - METAL DOWNSPOUT**
  - K1.1 PRE-FINISHED METAL DOWNSPOUT  
COLOUR = WHITE
- L - LIGHTS**
  - L1.1 WALL MOUNTED  
COLOUR = BLACK
- M - SIGNAGE**
  - M1.1 METAL ADDRESS NUMBER  
COLOUR = BRUSHED NICKEL
- N - SERVICES**
  - N1.1 SERVICES PANEL SURROUND TRIM / PANEL  
COLOUR = TO MATCH ADJACENT FINISH



**1 SIDE ELEVATION (SW)**  
DP.603 1/8" = 1'-0"

**2 FRONT ELEVATION (SE)**  
DP.603 1/8" = 1'-0"



**3 SIDE ELEVATION (NE)**  
DP.603 1/8" = 1'-0"

**4 REAR ELEVATION (NW)**  
DP.603 1/8" = 1'-0"



FORMED ALLIANCE ARCHITECTURE STUDIO

FOR REFERENCE ONLY - NOT FOR CONSTRUCTION

**RELEASES**

NO	DESCRIPTION	DATE
B	DP LITE	2024.06.19

CONSTRUCTION  
 TENDER  
 BUILDING PERMIT

MUNICIPAL ADDRESS  
**CHESTERMERE, AB**

LEGAL ADDRESS

PROJECT NUMBER  
**24.23 TRU\_WR**

DRAWN  
**KIA**

CHECKED  
**AMH**

DATE  
**2024.06.19**

SCALE  
**As indicated**

DRAWING TITLE  
**EXT. ELEV. (5PLEX) COLOR SCHEME 3 - BLDG 3,6,7,9**

DRAWING NUMBER

**DP.603**

FILE PATH: A:\dwg\Drawings\176\WATERBURY\176-0327\176-TRU\_WR\_5PLEX\_BLDG3,6,7,9\_BLDG\_02.dwg  
 PLOT DATE: 2024/06/19 09:21 AM

Copyright reserved. This drawing and all copyright therein are the sole and exclusive property of the consultant. Reproduction or use of this drawing in whole or in part is prohibited and may not be used without the written consent of FAAS Architecture. Do not scale this drawing.