

± 643 SQ. FT.  
2 BED  
1 BATH

B

\*balcony location  
varies with floor level/exposure

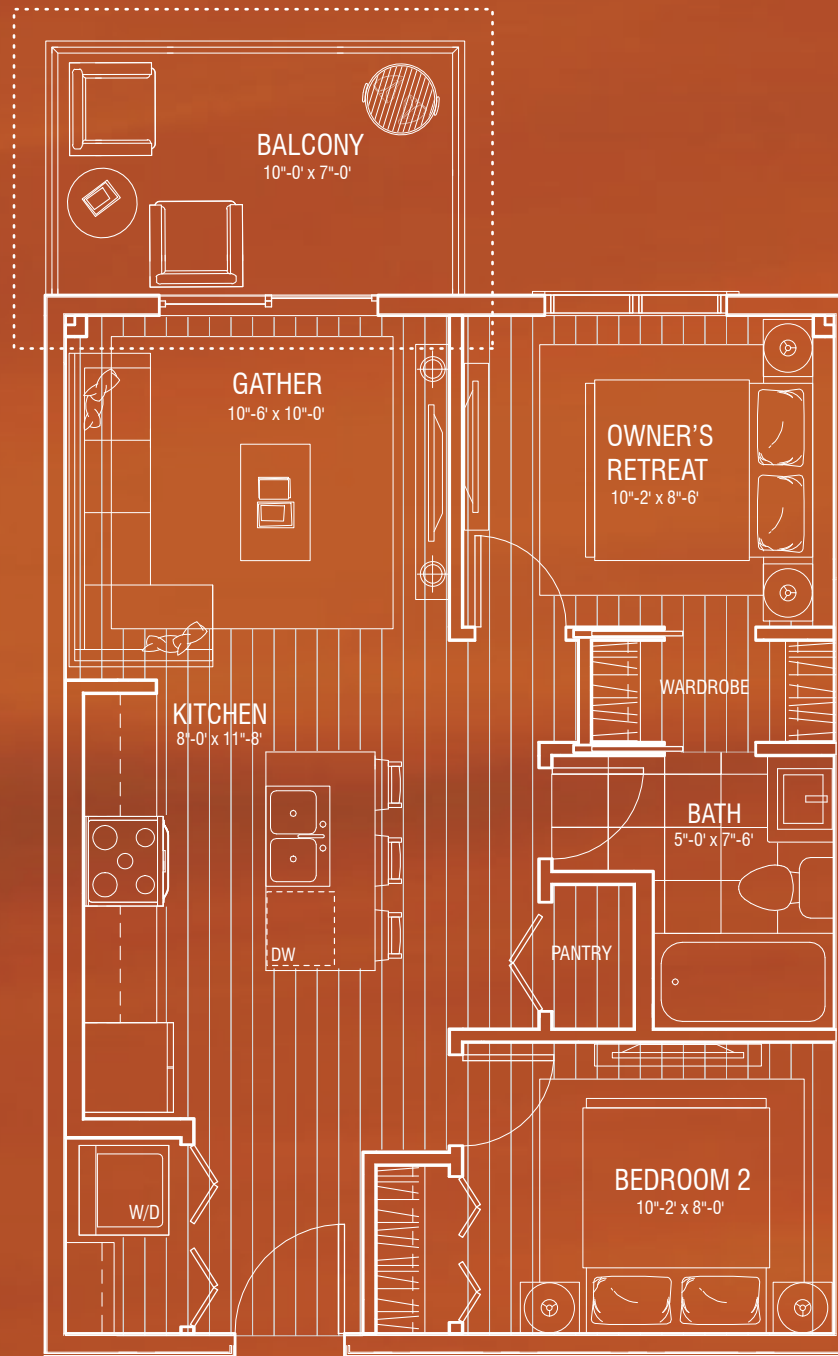



*\*wardrobe layout varies  
with floor level/exposure*

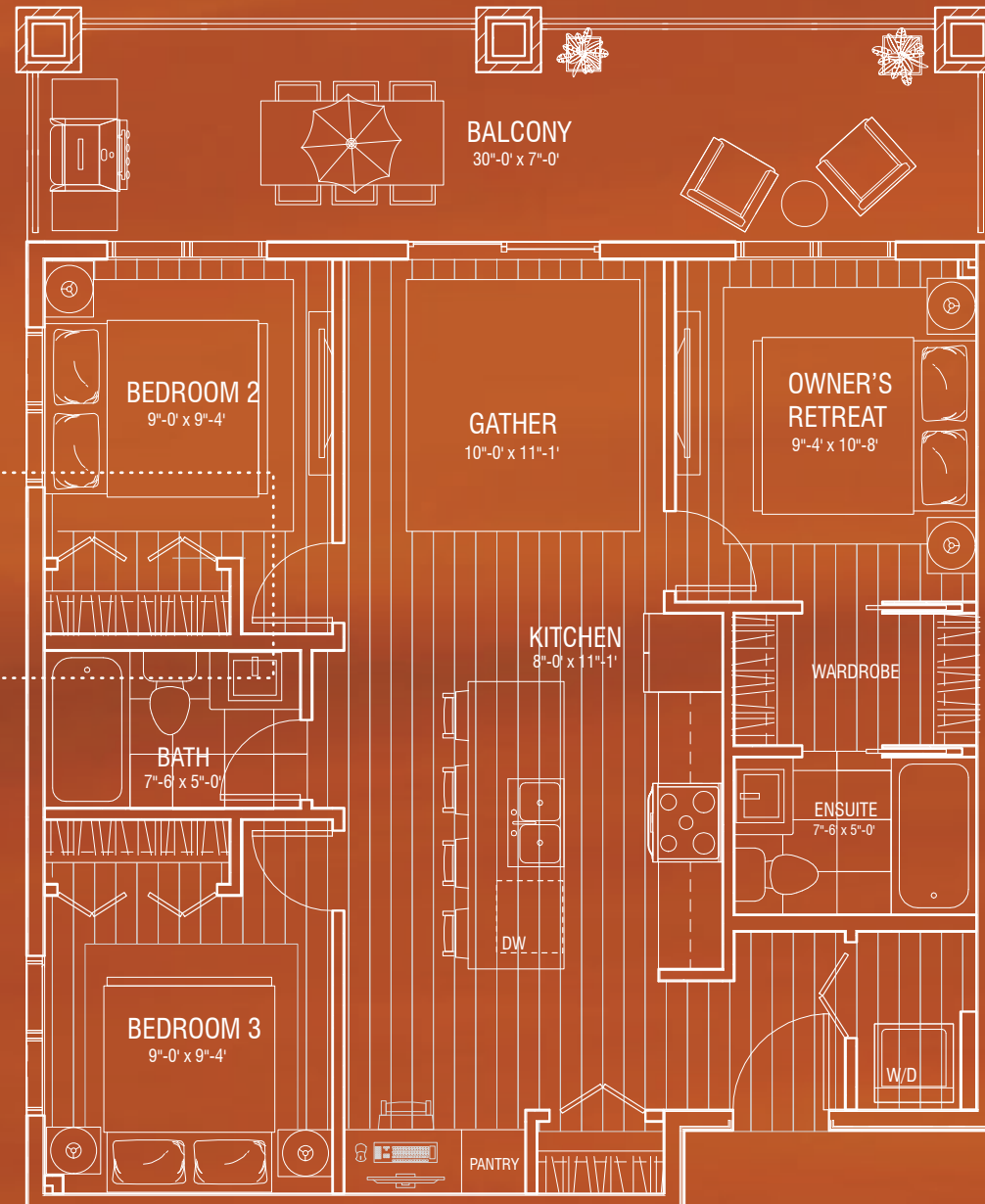

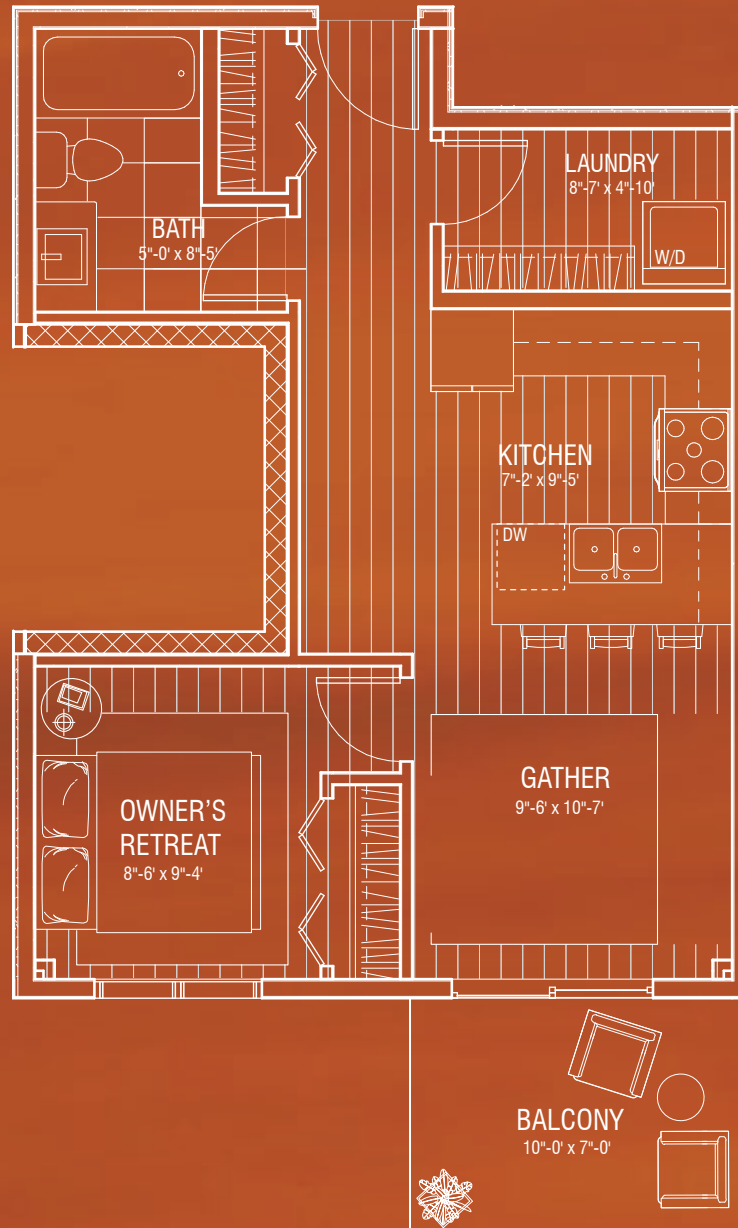

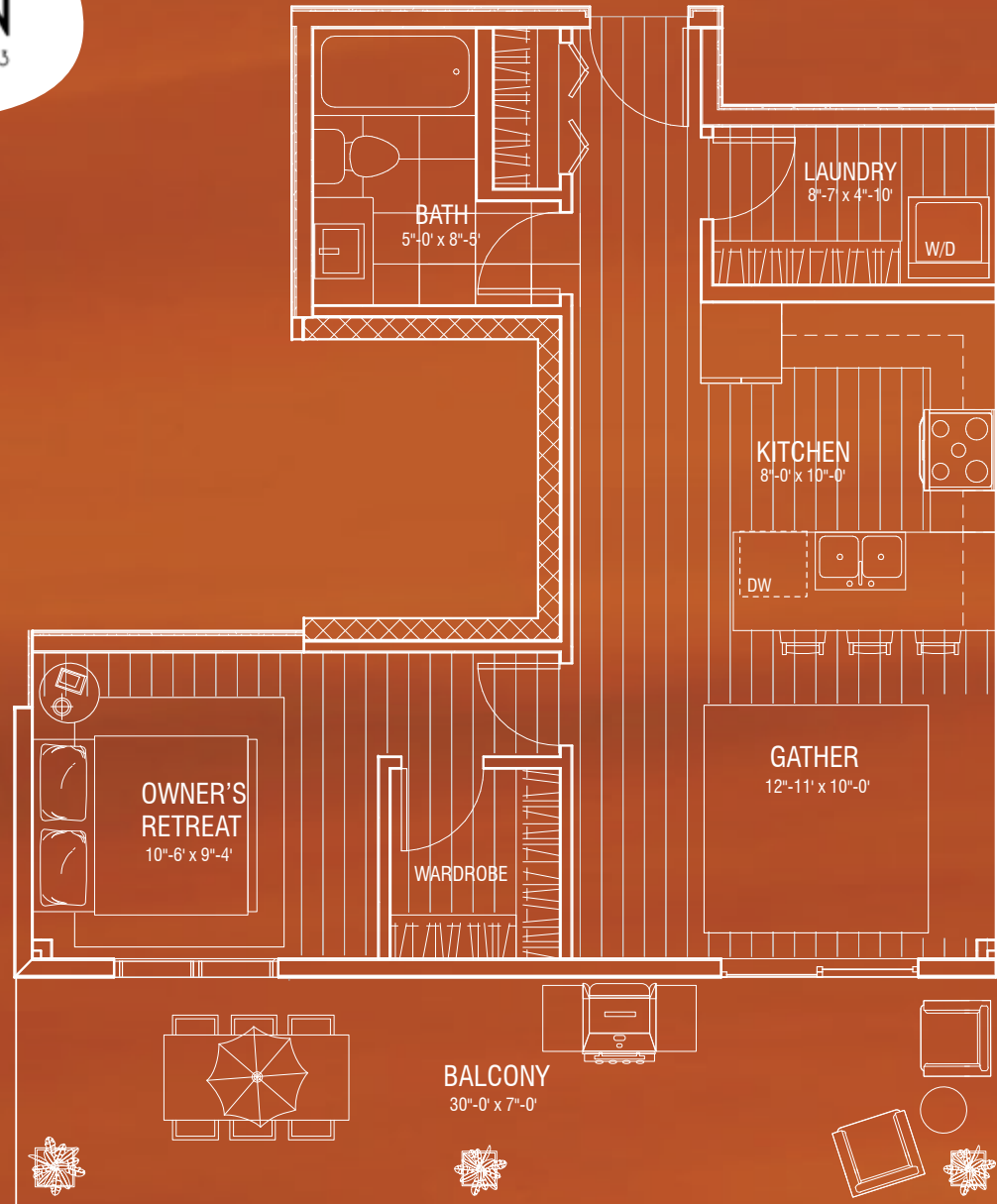

## L.A. COLOUR

### Flooring

1. LVP – Divine Quest Willow XL
2. LVT – Divine Passage Cleopatra  
(laundry / bathrooms)

### Tile Backsplash

3. White Subway Tile  
(kitchen / shower walls)

### Countertops

4. Quartz – GS Imports Glacier White  
(kitchen / bathrooms)

### Cabinetry

5. White - Chill (H56) (kitchen)

### Paint

6. Architectural White C2 – 516  
(walls / trim)

## N.Y. COLOUR

### Flooring

1. LVP – Divine Quest Willow XL
2. LVT – Divine Passage Cleopatra  
(laundry / bathrooms)

### Tile Backsplash

3. White Subway Tile  
(kitchen / shower walls)

### Countertops

4. Quartz – GS Imports Glacier White  
(kitchen / bathrooms)

### Cabinetry

5. White - Haze (H57) (kitchen)

### Paint

6. Architectural White C2 – 516 (trim)
7. Spray River 1048W (walls)

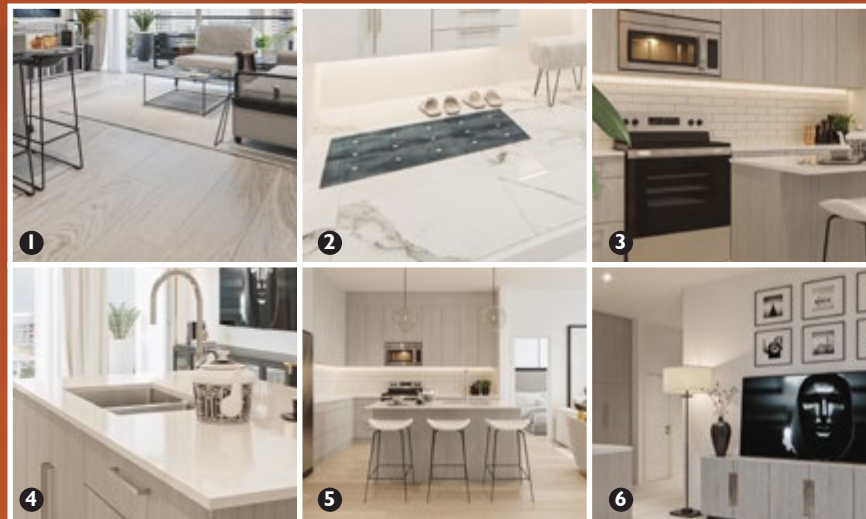
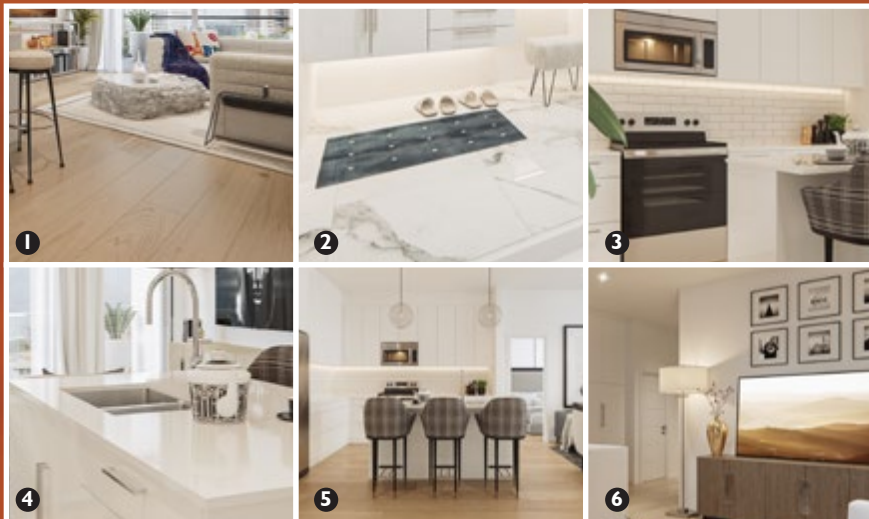

**SELECTION:**  
(Type NY or LA) \_\_\_\_\_



## THE BUILDINGS

- Built by multiple Customer Choice Award Winner for highest customer satisfaction, Truman
- Peace of mind provided through our comprehensive warranty program: 1 Year on Workmanship & Materials, 2 Year Warranty of Delivery & Distribution Systems, 5 Year Building Envelope Coverage, and a 10 Year Structural Warranty.
- Energy efficient design including mechanical and distribution systems
- Comprehensive coverage including deposit payments are protected by the Alberta New Home Warranty Program
- Maintenance free exteriors featuring private decks, patios and professionally designed and irrigated grounds
- Built-in smoke/heat detectors and in-suite water sprinkler system
- Individual suite utility metering for maximum energy savings, coupled with individual thermostat for temperature control
- Painted, secured, and heated underground parkade with secured storage areas
- Intercom and security monitoring system in lobby

## THE SUITES

- Beautifully appointed interiors by our award-winning interior design team with a choice of 2 timeless interior colour schemes; L.A. and N.Y.
- Approximate  $\pm 9$ ft ceilings throughout suite (*excluding dropped areas required for mechanical, plumbing and/or electrical*)
- Energy efficient windows and oversize doors/patio sliders (*as per plan*)
- Custom designed solid core entry door with security view-hole and custom printed address plate, accented by individual suite lighting fixture at entrance
- A choice of two high quality luxury vinyl plank flooring with acoustic underlay throughout all living areas, LVT in bath and laundry areas
- In-suite technology featuring integrated wiring panel
- Smart Plug USB plug jack connection, and TV / Telephone connections in principal area
- Convenient and ultra-quiet in-suite Energy Star® front-load stacking washer and dryer centre, vented to the exterior with quick water shut off valve
- Brilliant lighting with our hand-picked energy efficient contemporary light fixtures throughout
- Elle designer window treatment package for all windows
- Smooth panel doors with levered anti scuff and scratch Taymor® door hardware throughout
- Modern sleek line profiled painted baseboards, door frames and casings
- Ample closet and storage shelving (*as per plan*)

## **THE BATHROOMS**

- Polished hard surface quartz eased edge countertops
- Modern square edge tubs with sloping lumbar support accented by contemporary tiles, creating a luxe spa atmosphere Innovative TRUspace™ integrated storage cabinetry
- TRUspace™ vanity design with maximum storage in mind
- Chrome plumbing fixtures with porcelain sink
- Sterling porcelain toilet
- Matching bathroom hardware and accessories
- Environmentally conscious WaterSense® fixtures, shower heads, and toilets
- Safety and pressure-balancing mixing valves for tub and showers

## **THE KITCHENS**

- Award winning kitchen cabinetry design by A.B. Cushing Mills with a choice of two colour palettes
- Floor to ceiling ergonomic TRUspace™ contemporary kitchen cabinetry featuring premium finishes, accented by soft close door and drawer hardware and integrated storage
- Polished hard surface quartz eased edge countertops
- Undermount stainless steel sink with industrial high arc single lever pull out faucet
- Contemporary imported off ceramic brick tile with custom set full height kitchen backsplashes
- Gleaming Foundry™ custom made door hardware
- Energy saving Whirlpool® stainless steel appliance package including fridge, dishwasher, microwave with integrated hood fan, and slide-in electric range
- Deep drawer for pots and pan